

Combined Dimensions Of Two Different Cabinets

The TW21-OR series is available in two cabinet heights (500mm and 1000mm), enabling multiple combinations and quick installation via connecting plates, ensuring an efficient setup and customized visual experience for every application.

High Quality Die-Casting Aluminum

TW21-OR screen used high-quality die-cast aluminum cabinets that are durable, lightweight, and easy to install. These cabinets enhance heat dissipation and provide superior protection against moisture and dust, ensuring prolonged lifespan and consistent performance. Ideal for venues that demand reliability and ease of maintenance, they offer a seamless visual experience in any environment.

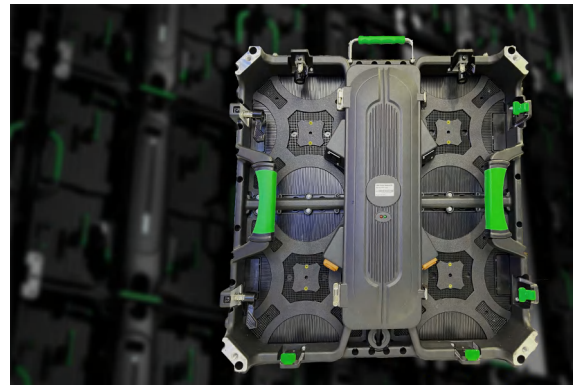

Calming Appearance

TW21-OR screen feature a calming appearance and are user-friendly, with a modular, lightweight structure for effortless transportation and installation. Quick Locks and an Angle Adjustment Lock allow for secure assembly and flexible angle adjustments, enabling curved display configurations tailored to any event's specific needs, enhancing visual engagement and setup efficiency.



- 1: Handle
- 2: Quick lock
- 3: Module handle
- 4: Connection lock with angle adjustment
- 5: Aviation socket

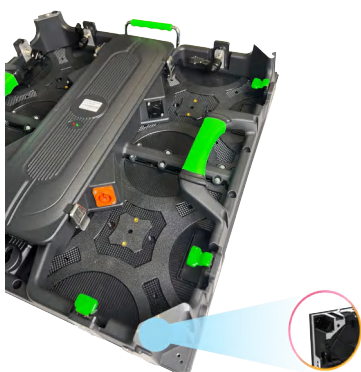

Edge Protection Design (Option)

Protective corners on our LED display enclosures safeguard the edges and corners against collisions and damage during installation or transportation. This critical feature not only extends the lifespan of the display but also ensures its reliability and performance, providing peace of mind in various settings from event staging to permanent installations.

Fast Installation

Hanging lock system for fast installation, time-saving.



Curvature Setting, Easy And Precise

keeps the curve range of $\pm 15^\circ$ and presents creative shapes.

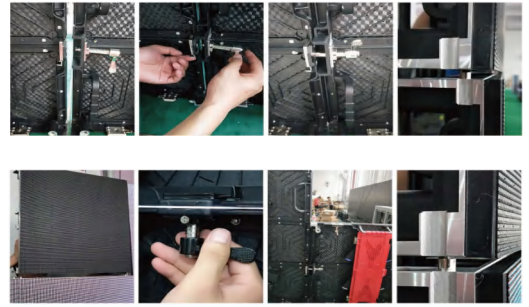

Waterproof Performance

Our IP65 waterproof LED modules offer exceptional protection against extreme weather, ensuring stable performance and longevity. The fanless power supply with waterproof seals further guarantees durability and reliable operation.

APPLICATION SCENARIO



